



# MATERIALS MANAGEMENT

## RIGHT MATERIALS. RIGHT PLACE. RIGHT TIME.

Through GIS' strategic and exclusive technology driven partnership with MODS, our team is able to deliver new and innovative solutions to the energy industry. MODS Connect offers a cloud-based solution that integrates with the customers existing processes to significantly decrease administrative burdens, reduce costly errors and easily integrates people, processes, and technology regardless of location. One of the components within the MODS Connect software includes Materials Manager which allows GIS to track hundreds of thousands of warehouse items which are managed from receipt to installation without loss. The software provides a seamless management system of tracking materials with real time updates whether in the yard or on site.



 **MODS Connect**

 Innovative solution that increases productivity and reduces costs

### MATERIALS MANAGEMENT CAPABILITIES:

- Procurement data imported into the system
- Link bulk purchase orders with Connect Work Pack
- Perform material management by Work Pack / Job Card
- Schedule to communicate the readiness of materials
- Barcode / RFID technology
- Provide real-time material tracking to improve productivity and efficiency
- Spares management
- Photographic functionality for easy identification to improve logistics
- Warehouse inventory management
- Perform internal warehouse transfer tracking
- Deck Space Management & Visualization
- Automatic report generation
- Provide historical tracking for all items
- Losses can be eliminated
- **COSTS CAN BE REDUCED**  **Materials Manager**

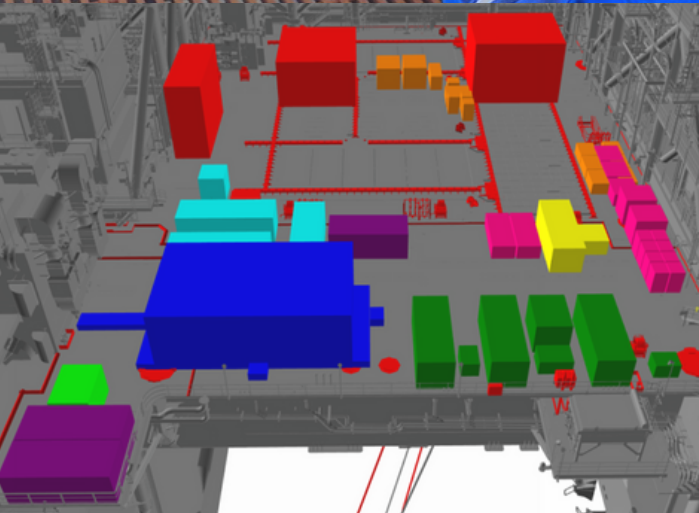

## ABOUT US

Established in 1948, GIS is a 70+ year-old full-service design, fabrication, and construction contractor that is centered on the people that make up the organization. GIS offers clients a single point of contact to utilize our 20+ strategically located facilities, ~3,200 employees, and 22 service lines. Serving Energy, Industrial, Infrastructure, and Power markets, we align our services with operations from the conceptual stage through construction, commissioning, and asset maintenance.

For more information on our company, you can visit [www.gisy.com](http://www.gisy.com).

## SAFETY

**LIFE** is the proactive, operational, and behavior-based component of GIS's comprehensive safety management program. While our Corporate HSE group focuses on compliance, training, and incident response, the LIFE processes specifically cover Operational Safety, through: comprehensive work planning; increasing awareness of work area & task risks; intervention techniques for redirecting at-risk behaviors; embedded field presence; quarterly initiatives focused on observed areas of risk; and visible leadership engagement all while encompassing the Human Performance Improvement Principles.

## PEOPLE

GIS employees are at the heart of our business. We are committed to developing and sustaining long-standing relationships with both our internal and external clients. Each employee is committed to excellence and continuous improvement. We understand the personal component of our business and are built upon core values that drive a partnership-minded approach to providing valued solutions to our clients while understanding our clients' operations, goals, and bottom line drivers. Our people believe greater value is created by aligning our goals with those of our clients and striving for innovation and excellence with every opportunity.



# PUTTING PEOPLE FIRST

## SINCE 1948

---

### CORPORATE HEADQUARTERS

18838 HWY 3235 | GALLIANO, LA 70354

### CONTACT INFORMATION

**Matt Lackie | MODS Systems Manager**

713.783.0300 | [matt.lackie@modsmanagement.com](mailto:matt.lackie@modsmanagement.com)

**Larry Nguyen | Sr. Project Manager (Galliano Warehouse)**

985.475.1061 | [lnguyen@gisy.com](mailto:lnguyen@gisy.com)

### OFFICE LOCATIONS

#### LOUISIANA:

Abbeville | Baton Rouge | Broussard | Brusly | Cut Off | Fourchon  
Franklinton | Galliano | Houma | Lafitte | Larose | Napoleonville  
New Orleans | New Roads | Thibodaux | Youngsville

#### OKLAHOMA:

Edmond

#### TEXAS:

Baird | Houston | Odessa



985.475.5238

[proposals@gisy.com](mailto:proposals@gisy.com)